



BEAUTY ESCAPE

HOTEL COURTESY SET



Beauty Escape Made in Italy	3
The fragrances	4
The ingredients	6
The design	8
The commitment for the environment	10
Afrodite and Atlantis product range	12
Arbory and Setai product range	30
The refill products	36
The accessories	44
Executive tables	50



Where luxury meets dreams

The Beauty Escape courtesy set is a sensory journey, an experience that transforms every moment into an opportunity to regenerate and indulge in beauty.

Inspired by discreet elegance and the most authentic well-being, the line combines advanced cosmetic formulas and refined fragrances, created to celebrate Italian excellence.

Beauty Escape evokes the symbolic imagery of Abano Terme, its place of origin. A place that resonates with elegance, self-care and refinement, attended by an international elite tourism, also summoned by the nearby, splendid Venice.

The philosophy of our line

Elegant refinement: products that embody the essence of luxury and attention to detail, just like the prestigious Venetian villa where Beauty Escape was born.

Care and wellness: advanced cosmetic formulas, the result of intense and specialised research, combining natural ingredients and innovation to offer a true wellness experience.

Made in Italy: a line that celebrates Italian excellence, with fragrances and textures designed for an international audience, in collaboration with prestigious Perfume houses.



Beauty Escape fragrances: memorable olfactory notes

Each fragrance tells a story and each texture gently envelops, transforming self-care into a unique, refined and unforgettable experience.

Atlantis

A vibrant and sophisticated harmony, combines citrus freshness, floral elegance and musky depth. Its top notes, with a burst of lemon, grapefruit and peach, offer a crisp and sunny opening. The middle and base notes add a touch of delicacy and refinement.



Afrodite

Is an ode to sensuality, for a refined and regenerating sensory experience. Its top notes, bright and vibrant, immediately capture the senses. The middle and base notes add an enveloping and spicy sweetness, creating a warm and seductive heart.



Arbory

With its floral and fruity notes, gives an enveloping refreshing feeling. Violet and white flowers intertwine with a delicate green note and a touch of apple, creating an elegant and refined harmony.



Setai

Opens with a fresh explosion of aromatic notes, enriched by a touch of lavender and sage. This combination gives an immediate sensation of freshness and elegance, capturing the senses from the first moment.





Excellent ingredients for a wellness experience

The Beauty Escape courtesy line has been designed to give you a wellness experience. The range of body wash and hand soaps is distinguished by formulations rich in active ingredients that work in synergy to offer the skin intense hydration, a soft texture and a radiant appearance.



Hyaluronic acid

It is a high-weight molecule present in the connective tissue of the skin. Thanks to its ability to retain water, it acts on the maintenance of the skin's water balance, and has strong moisturising, repairing and regenerating properties of the tissues.



Glycerin

A small molecule of plant origin able to retain the moisture of the skin, guaranteeing deep hydration, which lasts over time, and an immediately radiant appearance.



Panthenol

Known as Vitamin B5, it has several important properties for the skin: it has moisturising, soothing and protective properties against skin irritation.



Vitamin E

It is an active ingredient known to protect against oxidative damage, improve hydration, skin elasticity and accelerate cell renewal processes.



Design and functionality: elegance at the service of hospitality

The Beauty Escape line combines functional design and refined aesthetics.

The bottle of the Atlantis and Afrodite lines, sinuous and refined, has been designed not only to be functional, but also to decorate the bathroom environment of hotel rooms, with an elegant and harmonious touch.

This bottle can be used in two ways: resting on the shelf or fixed to the wall by means of an elegant bracket. The latter solution guarantees that the bottle remains intact, an extra security for the hotelier.

Main features

Sustainability: refillable bottles allow the reduction of single-use plastic.

Safety: the bottles anchored to the brackets ensure total inviolability and prevent any possible contamination, for maximum safety.

Ease of use: the practical opening system of the brackets allows speedy replacement of the bottle.





With Beauty Escape, hospitality is even more environmentally conscious

The Beauty Escape line combines elegance and respect for the environment, with solutions designed to reduce ecological impact.

Refillable bottles

Reduce single-use plastic and limit product waste, giving hotels a sustainable option.



Paper refills

Are made of predominantly cellulose material, FSC certified for responsible forest management and Aticelca, which certifies the recyclability of the bottle with paper, according to the UNI 11743:2019 standard. They represent a further focus on environmental issues step towards a greener future.

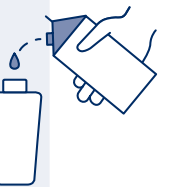

Ecolabel products

The line includes Ecolabel certified products, such as Arbory, which combine skin care and respect for the environment, ensuring eco-friendly formulations.





*Discover Atlantis and Afrodite
in Beauty Escape:
a sensory experience that combines
luxury and well-being*

Every detail of the Beauty Escape courtesy set, from enveloping textures to olfactory notes, is designed to evoke unique emotions.

With products such as body wash, hand soap, shampoo, conditioner and body cream, with Beauty Escape self-care becomes a moment of pure refinement.



Atlantis



Atlantis

The fragrance of the Atlantis range celebrates vitality and elegance, thanks to natural extracts such as lemon, orange and lavender notes, ideal for those who want a sparkling and energetic sensory experience.



Top notes

A burst of lemon, grapefruit and peach, enriched by the freshness of petit grain, gives a lively and cheerful opening.

Middle notes

The floral heart, with lavender and orange flowers, adds a touch of delicacy and refinement.

Base notes

The musky base envelops with a warm and enchanting, perfect for those looking for a balance between energy and relaxation.



Atlantis Shower gel
ATL100

Moisturising body wash, with vibrant citrus notes, leaves skin energised and deeply hydrated. The formula, enriched with glycerin and hyaluronic acid, nourishes and gives elasticity to the skin. Dermatologically tested, it is suitable for all skin types, even the most sensitive.



Hydrating



Dermatologically tested



Hyaluronic Acid



Refillable bottle

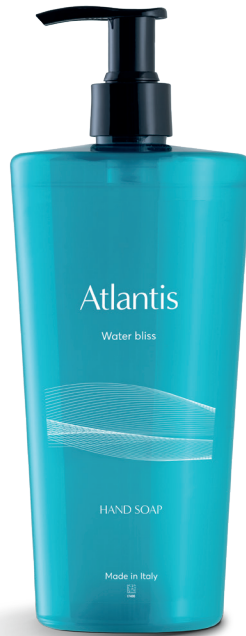

Atlantis Hand soap
ATL101

Hydrating liquid hand soap, dermatologically tested, pH neutral, respects even the most delicate skin. Its formula, enriched with hyaluronic acid and glycerin, cleanses the skin leaving it soft and energised.



Hydrating



Dermatologically tested



Hyaluronic Acid



Refillable bottle

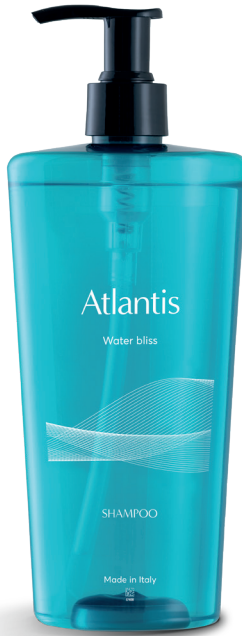

Atlantis Shampoo
ATL102

Shampoo enriched with coconut oil with nourishing action on the scalp and brightening effect on the hair. Gentle formula suitable for all hair types.



Brightening



Coconut oil



Refillable bottle



Atlantis Conditioner
ATL103

Conditioner based on soy protein with a strengthening action on the hair. Its formula is enriched with agents that facilitate hair combing.



Strengthening



Soy proteins



Atlantis Body lotion
ATL104

Body cream enriched with almond and sunflower oil with emollient action on the skin. Its formula contains vitamin E, with protective and antioxidant properties.



Hydrating



Vitamin E



Almond oil

The brackets

The bracket solution guarantees bottle inviolability and prevents any contamination for an extra security.



400 ml bottle



Wall Kit

The refill products

They enable the reduction of single-use plastics, also limiting waste of product and thus helping hotels to reduce their environmental impact.



1L paper-based refill

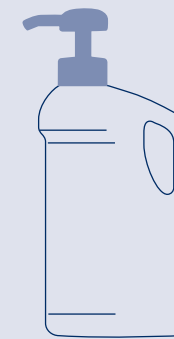

5L can



The Air freshener

Atlantis Air freshener ATL111

Long-lasting fragrance for rooms and fabrics, also suitable for perfuming carpets and rugs. An intertwine of fresh and floral notes, with an explosion of Ylang Ylang and Rose that evoke vitality and elegance, for a fresh and refined atmosphere.



Up to 24h



Rooms and
fabric



300 ml



Afroditë



Afrodite

The fragrance of the Afrodite line celebrates the art of seduction, perfect for those who want a rich, elegant and memorable olfactory experience.



Top notes

Bergamot opens the fragrance with a bright and lively citrus note, which immediately captures the senses.

Middle notes

Tonka beans in the centre add an enveloping and spicy sweetness, creating a warm and seductive heart.

Base notes

The vanilla and moss base envelops with a creamy and sensual softness, leaving an unforgettable scent.





Afrodite Shower gel
AFR100

Moisturising body wash with enveloping and sensual notes, they transform the moment of the shower into a moment of true well-being. Its formula, with moisturising and nourishing properties, gently cleanses the skin, leaving a soft feeling.



Afrodite Hand soap
AFR101

Moisturising hand soap with enveloping and sensual notes. Its formula with hyaluronic acid with moisturising properties leaves the skin soft and fragrant.



Afrodite Shampoo
AFR102

Shampoo enriched with coconut oil with nourishing action on the scalp and brightening effect on the hair. Gentle formula, suitable for all hair types.



Afrodite Conditioner
AFR103

Conditioner based on corn protein with protective action on the hair. Its formula is enriched with agents that help keep hair nourished and full-bodied.



Afrodite Body lotion
AFR104

Body cream enriched with chamomile extract with a soothing and gentle action on the skin. Its formula contains vitamin E, with protective and antioxidant effects.



The brackets

The bracket solution guarantees bottle inviolability and prevents any contamination for an extra security.



400 ml bottle

Wall Kit

The refill products

They enable the reduction of single-use plastics, also limiting waste of product and thus helping hotels to reduce their environmental impact.



1L paper-based refill

5L can

The Air freshener

Afrodite Air freshener AFR111

Long-lasting concentrated fragrance for rooms and fabrics, also suitable for perfuming carpets and rugs. The warm notes of Sandalwood and Patchouli combine with the sensual notes of Geranium and Jasmine for a sophisticated and sensual fragrance.



Up to 24h



Rooms and
fabric



300 ml



Arbory and Setai



ARBORY

Arbory is a courtesy set that combines the wisdom of its formulations with respect for the environment. Arbory's fragrance is a delicate and refined harmony, combining aquatic freshness with fruity sweetness and floral refinement, creating unique sensorial experience, an opportunity to celebrate the nature.



Arbory Body wash
AR2030



Arbory Body Wash is an Ecolabel-certified body care cleanser, with a gentle formulation based on natural ingredients. Its fresh aromatic fragrance leaves a pleasant scent on the skin. Its dermatologically tested formula is a guarantee of safety and quality.



Dermatologically tested



Arbory Hand wash
AR1020



Arbory Hand Soap is an Ecolabel-certified daily hand cleansing soap. Its delicate formula, enriched with a pleasant aromatic fragrance, leaves a feeling of softness after each wash. Dermatologically tested, it is also suitable for the most sensitive skin.



Dermatologically tested

Olfactory pyramid

Top notes: the fragrance opens with an explosion of floral and fruity notes, where the melon gives a vibrant and immediately enveloping freshness.

Middle notes: at its heart, violet and white flowers intertwine with a delicate green note and a touch of apple.

Base notes: the base wraps up with the creamy softness of peach, leaving a persistent and unforgettable note.



The brackets

The bracket solution guarantees bottle inviolability and prevents any contamination for an extra security.

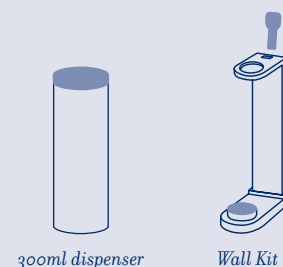

300ml dispenser

Wall Kit

Setai



Setai Hair & Body wash SE2030

Setai Shampoo and Shower Gel is a body and hair cleanser formulated to offer a gentle cleansing of the skin and scalp. The product is dermatologically tested and suitable for even the most sensitive skin.



Setai Hand wash SE1020

Setai Hand Soap is a cleanser for daily hand hygiene. Its delicate, dermatologically tested formula preserves the skin's natural hydration.



Olfactory pyramid

Top notes: the fragrance opens with a fresh explosion of bright and clean notes, enriched by a touch of lavender and sage.

Middle notes: at its heart, ylang-ylang, rose and jasmine create a rich and sophisticated floral heart.

Base notes: the base wraps up with the smoothness of moss and vanilla, enriched by the enveloping sweetness of tonka beans.



The brackets

The bracket solution guarantees bottle inviolability and prevents any contamination for an extra security.

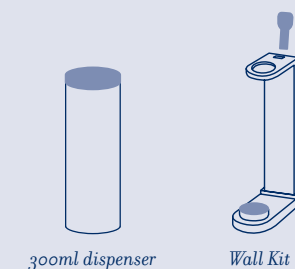

Cellulose-based refills: sustainable, practical, without product waste

Beauty Escape confirms its commitment to sustainability with refills in FSC® certified cellulose-prevalent material, for responsible forest management. In addition, the refill has obtained the Aticelca certification, that certifies the recyclability of the bottle in the paper collection, simplifying the recycling process.

This innovative design not only reduces the use of plastic significantly, combining practicality and respect for the environment, but has also been designed to make its use easier for the operator.

The refill bottle is in fact solid and easy to handle and thanks to these characteristics, it can be used with one hand. Its shape also allows precise application, avoiding any product waste.



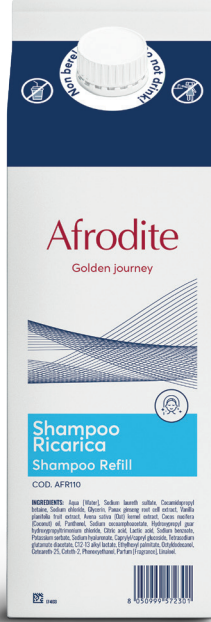
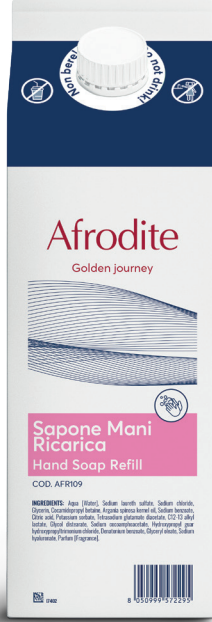
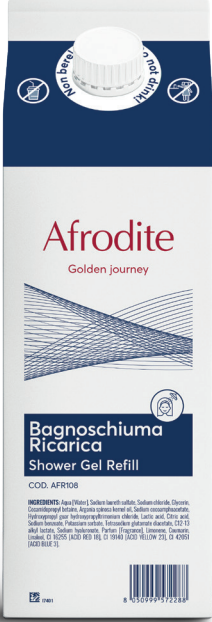
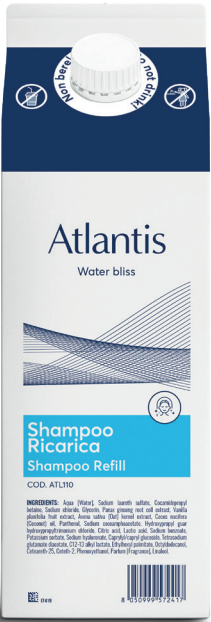
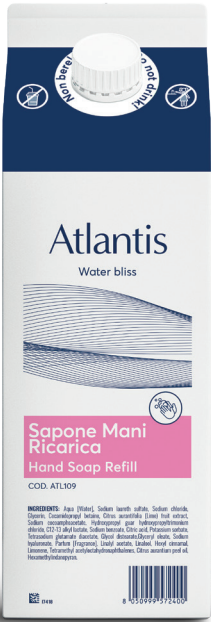
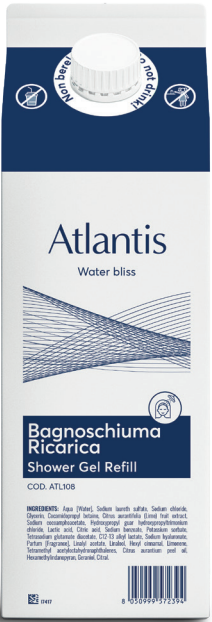

Atlantis Shower gel refill box ATL108

Moisturising body wash, with vibrant citrus notes, leaves skin energised and deeply hydrated. The formula, enriched with glycerin and hyaluronic acid, nourishes and gives elasticity to the skin. Dermatologically tested, it is suitable for all skin types, even the most sensitive.



Atlantis Hand soap refill box ATL109

Hydrating liquid hand soap, dermatologically tested, pH neutral, respects even the most delicate skin. Its formula, enriched with hyaluronic acid and glycerin, cleanses the skin leaving it soft and energised.



Atlantis Shampoo refill box ATL110

Shampoo enriched with coconut oil with nourishing action on the scalp and brightening effect on the hair. Gentle formula suitable for all hair types.



Afrodite Shower gel refill box AFR108

Moisturising body wash with enveloping and sensual notes, they transform the moment of the shower into a moment of true well-being. Its formula, with moisturising and nourishing properties, gently cleanses the skin, leaving a soft feeling.



Afrodite Hand soap refill box AFR109

Moisturising hand soap with enveloping and sensual notes. Its formula with hyaluronic acid with moisturising properties leaves the skin soft and fragrant.



Afrodite Shampoo refill box AFR110

Shampoo enriched with coconut oil with nourishing action on the scalp and brightening effect on the hair. Gentle formula, suitable for all hair types.



Refills 5L

The 5L can allows the refilling of the 400ml bottles with the help of the practical dispenser, so as to avoid replacing the products once they are used up, allowing a reduction in plastic waste for the hotels.





Atlantis Shower gel refill box
ATL105

Moisturising body wash, with vibrant citrus notes, leaves skin energised and deeply hydrated. The formula, enriched with glycerin and hyaluronic acid, nourishes and gives elasticity to the skin. Dermatologically tested, it is suitable for all skin types, even the most sensitive.



Atlantis Hand soap refill box
ATL106

Hydrating liquid hand soap, dermatologically tested, pH neutral, respects even the most delicate skin. Its formula, enriched with hyaluronic acid and glycerin, cleanses the skin leaving it soft and energised.



Atlantis Shampoo refill box
ATL107

Shampoo enriched with coconut oil with nourishing action on the scalp and brightening effect on the hair. Gentle formula suitable for all hair types.



Afrodite Shower gel refill box
AFR105

Moisturising body wash with enveloping and sensual notes, they transform the moment of the shower into a moment of true well-being. Its formula, with moisturising and nourishing properties, gently cleanses the skin, leaving a soft feeling.



Afrodite Hand soap refill box
AFR106

Moisturising hand soap with enveloping and sensual notes. Its formula with hyaluronic acid with moisturising properties leaves the skin soft and fragrant.



Afrodite Shampoo refill box
AFR107

Shampoo enriched with coconut oil with nourishing action on the scalp and brightening effect on the hair. Gentle formula, suitable for all hair types.





Monodose

- DMHC1030 DERMOMED HOTEL COLLECTION VEGETABLE SOAP
- DMHC2040 DERMOMED HOTEL COLLECTION HAIR AND BODY WASH 10ML
- DMHC2050 DERMOMED HOTEL COLLECTION HAIR AND BODY WASH 30ML



Vanity Kit

- LCA0004 SHOWER CAP
- LCA0005 VANITY KIT
- LCA0006 SLIPPERS





BOTTLE FILLING PROCEDURE
Quick and waste-free dosing

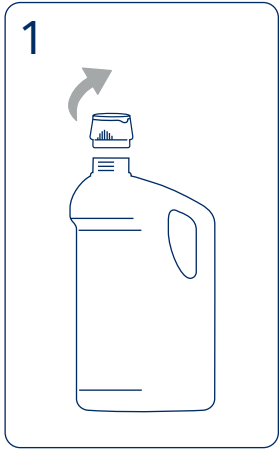

Remove the cap from the can

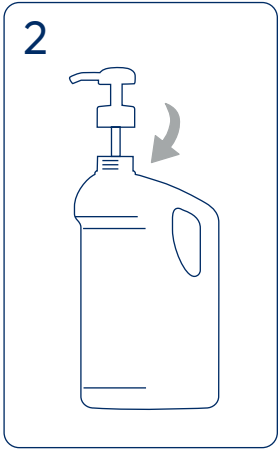

Insert the dispenser inside the can



Open the bottle, refill with the product and then close it

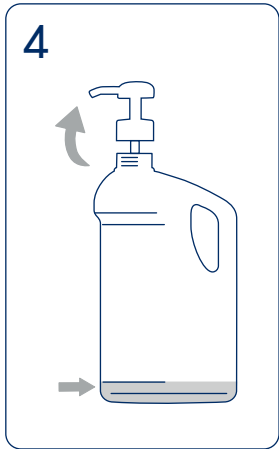

Once the can is empty, remove the dispenser from the can

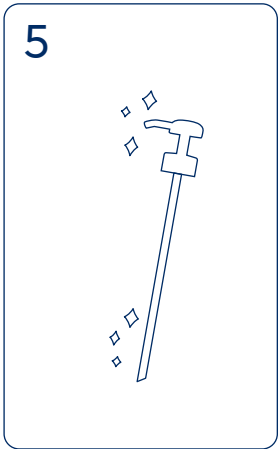

Sanitize the dispenser with a proper disinfectant solution

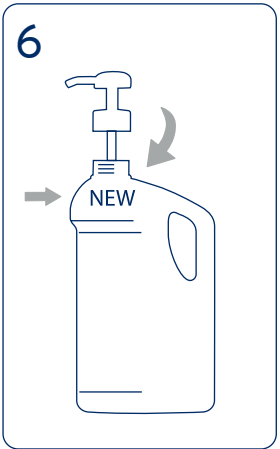

Insert the sanitized dispenser inside a new can



BRACKET INSTALLATION PROCEDURE

Ease of assembly and tamper-proof bottle

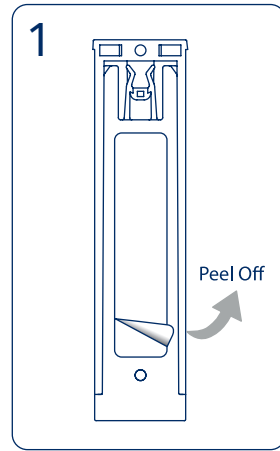

Remove the adhesive and stick the bracket on the wall

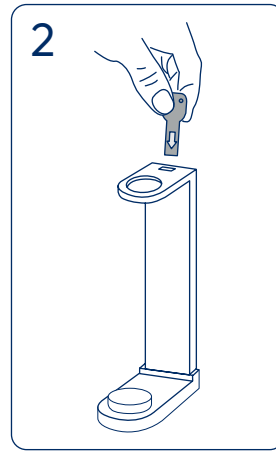

Through the appropriate key, unlock the bracket opening

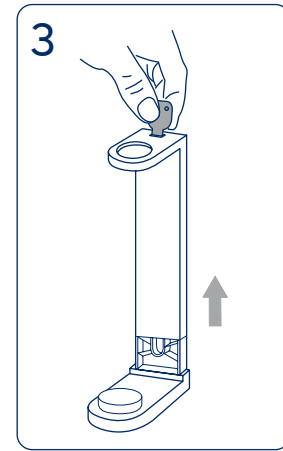

Remove the upper part of the bracket



Insert the bottle into the bracket, matching the bottle dispenser to the upper hole of the bracket

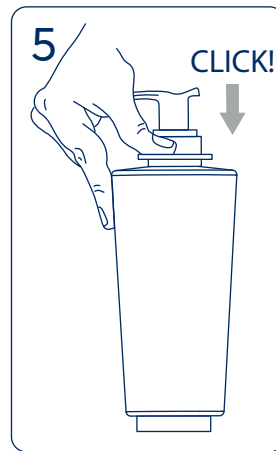

Lowers the upper movable part to make it fit into the bottle and remove the key



Find out more on your smartphone



ATLANTIS



CODE	DESCRIPTION	SIZE	EAN CODE	PIECES X BOX	PIECES X LAYER	PIECES X PALLLET
ATL100	ATLANTIS SHOWER GEL	400 ML	8050999572318	12	15	105
ATL101	ATLANTIS HAND SOAP	400 ML	8050999572325	12	15	105
ATL102	ATLANTIS SHAMPOO	400 ML	8050999572332	12	15	105
ATL103	ATLANTIS CONDITIONER	400 ML	8050999572349	12	15	105
ATL104	ATLANTIS BODY LOTION	400 ML	8050999572356	12	15	105

CODE	DESCRIPTION	SIZE	EAN CODE	PIECES X BOX	PIECES X LAYER	PIECES X PALLLET
ATL111	ATLANTIS DEOSPRAY	300 ML	8050999572981	12	24	144

CODE	DESCRIPTION	ITF CODE	PIECES X BOX
KIT_STAFFA	BLACK BRACKET	18050999572766	12 BRACKETS + 6 KEYS

AFRODITE



CODE	DESCRIPTION	SIZE	EAN CODE	PIECES X BOX	PIECES X LAYER	PIECES X PALLLET
AFR100	AFRODITE SHOWER GEL	400 ML	8050999572202	12	15	105
AFR101	AFRODITE HAND SOAP	400 ML	8050999572219	12	15	105
AFR102	AFRODITE SHAMPOO	400 ML	8050999572226	12	15	105
AFR103	AFRODITE CONDITIONER	400 ML	8050999572233	12	15	105
AFR104	AFRODITE BODY LOTION	400 ML	8050999572240	12	15	105

CODE	DESCRIPTION	SIZE	EAN CODE	PIECES X BOX	PIECES X LAYER	PIECES X PALLLET
AFR111	AFRODITE DEOSPRAY	300 ML	8050999572998	12	24	144

CODE	DESCRIPTION	ITF CODE	PIECES X BOX
KIT_STAFFA	BLACK BRACKET	18050999572766	12 BRACKETS + 6 KEYS

ATLANTIS REFILL



AFRODITE REFILL



CODE	DESCRIPTION	SIZE	EAN CODE	PIECES X BOX	PIECES X LAYER	PIECES X PALLET
ATL108	ATLANTIS SHOWER GEL	1000 ML	8050999572394	6	25	150
ATL109	ATLANTIS HAND SOAP	1000 ML	8050999572400	6	25	150
ATL110	ATLANTIS SHAMPOO	1000 ML	8050999572417	6	25	150
ATL105	ATLANTIS SHOWER GEL	5L /5,1 KG	8050999572363	2	18	72
ATL106	ATLANTIS HAND SOAP	5L /5,1 KG	8050999572370	2	18	72
ATL107	ATLANTIS SHAMPOO	5L /5,1 KG	8050999572387	2	18	72

CODE	DESCRIPTION	ITF CODE	PIECES X BOX
KIT_PUMP	DISPENSER	18050999573008	10 dispenser

CODE	DESCRIPTION	SIZE	EAN CODE	PIECES X BOX	PIECES X LAYER	PIECES X PALLET
AFR108	AFRODITE SHOWER GEL	1000 ML	8050999572288	6	25	150
AFR109	AFRODITE HAND SOAP	1000 ML	8050999572295	6	25	150
AFR110	AFRODITE SHAMPOO	1000 ML	8050999572301	6	25	150
AFR105	AFRODITE SHOWER GEL	5L /5,1 KG	8050999572257	2	18	72
AFR106	AFRODITE HAND SOAP	5L /5,1 KG	8050999572264	2	18	72
AFR107	AFRODITE SHAMPOO	5L /5,1 KG	8050999572271	2	18	72

CODE	DESCRIPTION	ITF CODE	PIECES X BOX
KIT_PUMP	DISPENSER	18050999573008	10 dispenser

SETAI AND ARBORY



AR1020



AR2030



SE1020



SE2030



DMPR008

CODE	DESCRIPTION	SIZE	EAN / ITF CODE	PIECES X BOX	PIECES X LAYER	PIECES X PALLLET
AR1020	ARBORY HAND WASH	300 ML	8054633838761	12	24	192
AR2030	ARBORY BODY WASH	300 ML	8054633838778	12	24	192
SE1020	SETAI HAND WASH	300 ML	8050999572530	12	24	192
SE2030	SETAI HAIR&BODY WASH	300 ML	8050999572547	12	24	192
DMPR008	BRACKET WHITE	--	18050444490218	12	--	--

MONODOSE AND VANITY KIT



DMHC1030



DMHC2040



DMHC2050



LCA0004



LCA0005



LCA0006

CODE	DESCRIPTION	SIZE	ITF CODE	PIECES X BOX	PIECES X LAYER	PIECES X PALLLET
DMHC1030	VEGETABLE SOAP	10 GR	18054633830106	400	10	40
DMHC2040	HAIR&BODY WASH	10 ML	18054633830113	600	10	40
DMHC2050	HAIR&BODY WASH	30 ML	18054633830120	300	12	48
LCA0004	SHOWER CAP	--	18054633830175	1000	6	18
LCA0005	VANITY KIT	--	18054633830182	500	5	20
LCA0006	SILPPERS	--	18054633830199	100	6	18



Beauty Escape is a brand of Italchimica's Professional Cosmetic Division

ITALCHIMICA S.r.l. Riviera Maestri del Lavoro, 10 - 35127 Padova (PD) - Italia

Tel. +39 049 8792456 - info@italchimica.it

italchimica.it

